

Nail Stake

Used to secure wood, or metal forms used in concrete work. Nail stakes have a machined point designed to make it easy to drive them through the ground. Stakes have holes for securing forms. Made of hand rolled carbon steel.

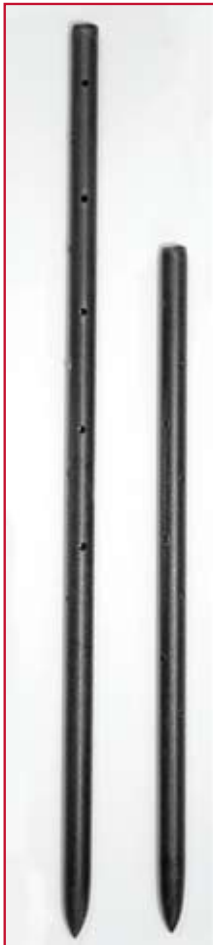

ITEM	DESCRIPTION	PCS/CTN	PCS/PLT
901008	3/4" x 12" Round Stake	10 pcs	1500
901015	3/4" x 18" Round Stake	10 pcs	1000
901022	3/4" x 24" Round Stake	10 pcs	750
901039	3/4" x 30" Round Stake	10 pcs	600
901046	3/4" x 36" Round Stake	10 pcs	500
901053	3/4" x 42" Round Stake	10 pcs	400
901060	3/4" x 48" Round Stake	10 pcs	350
901077	7/8" x 12" Round Stake	10 pcs	1000
901084	7/8" x 18" Round Stake	10 pcs	750
901091	7/8" x 24" Round Stake	10 pcs	500
901107	7/8" x 30" Round Stake	10 pcs	450
901114	7/8" x 36" Round Stake	10 pcs	350
901121	7/8" x 42" Round Stake	10 pcs	300
901138	7/8" x 48" Round Stake	10 pcs	250
901145	1" x 12" Round Stake	10 pcs	800
901152	1" x 18" Round Stake	10 pcs	600
901169	1" x 24" Round Stake	10 pcs	450
901176	1" x 30" Round Stake	10 pcs	350
901183	1" x 36" Round Stake	10 pcs	300
901190	1" x 42" Round Stake	10 pcs	250
901206	1" x 48" Round Stake	10 pcs	200
901213	18mm x 12" Round Stake	10 pcs	1500
901220	18mm x 18" Round Stake	10 pcs	1000
901237	18mm x 24" Round Stake	10 pcs	750
901244	18mm x 30" Round Stake	10 pcs	600
901251	18mm x 36" Round Stake	10 pcs	500
901268	18mm x 42" Round Stake	10 pcs	400
901275	18mm x 48" Round Stake	10 pcs	350

Nail Stake

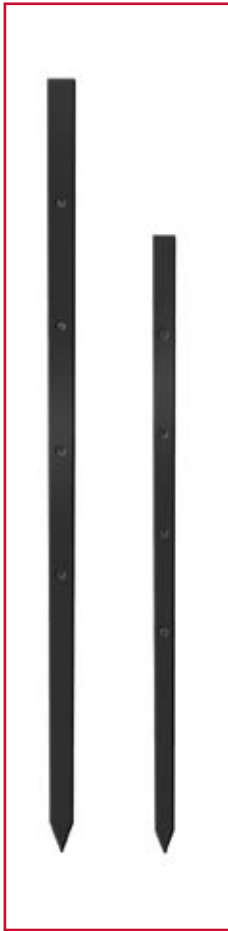

ITEM	DESCRIPTION	PCS/CTN	PCS/PLT
901282	3/8" x 1" x 12" Flat Stake "V-Type"	10 pcs	1500
901299	3/8" x 1" x 18" Flat Stake "V-Type"	10 pcs	1000
901305	3/8" x 1" x 24" Flat Stake "V-Type"	10 pcs	750
901312	3/8" x 1" x 30" Flat Stake "V-Type"	10 pcs	600
901329	3/8" x 1" x 36" Flat Stake "V-Type"	10 pcs	500
901336	3/8" x 1" x 42" Flat Stake "V-Type"	10 pcs	400
901343	3/8" x 1" x 48" Flat Stake "V-Type"	10 pcs	300
901350	3/8" x 1 1/2" x 12" Flat Stake "V-Type"	10 pcs	1200
901367	3/8" x 1 1/2" x 18" Flat Stake "V-Type"	10 pcs	800
901374	3/8" x 1 1/2" x 24" Flat Stake "V-Type"	10 pcs	550
901381	3/8" x 1 1/2" x 30" Flat Stake "V-Type"	10 pcs	450
901398	3/8" x 1 1/2" x 36" Flat Stake "V-Type"	10 pcs	400
901404	3/8" x 1 1/2" x 42" Flat Stake "V-Type"	10 pcs	350
901411	3/8" x 1 1/2" x 48" Flat Stake "V-Type"	10 pcs	300
901428	1/2" x 1 1/2" x 12" Flat Stake "V-Type"	10 pcs	650
901435	1/2" x 1 1/2" x 18" Flat Stake "V-Type"	10 pcs	450
901442	1/2" x 1 1/2" x 24" Flat Stake "V-Type"	10 pcs	350
901459	1/2" x 1 1/2" x 30" Flat Stake "V-Type"	10 pcs	300
901466	1/2" x 1 1/2" x 36" Flat Stake "V-Type"	10 pcs	250
901473	1/2" x 1 1/2" x 42" Flat Stake "V-Type"	10 pcs	200
901480	1/2" x 1 1/2" x 48" Flat Stake "V-Type"	10 pcs	150
901497	3/8" x 1" x 12" Flat Stake "C-Type"	10 pcs	1500
901503	3/8" x 1" x 18" Flat Stake "C-Type"	10 pcs	1000
901510	3/8" x 1" x 24" Flat Stake "C-Type"	10 pcs	750
901527	3/8" x 1" x 30" Flat Stake "C-Type"	10 pcs	600
901534	3/8" x 1" x 36" Flat Stake "C-Type"	10 pcs	500
901541	3/8" x 1" x 42" Flat Stake "C-Type"	10 pcs	400
901558	3/8" x 1" x 48" Flat Stake "C-Type"	10 pcs	300

Nail Stake

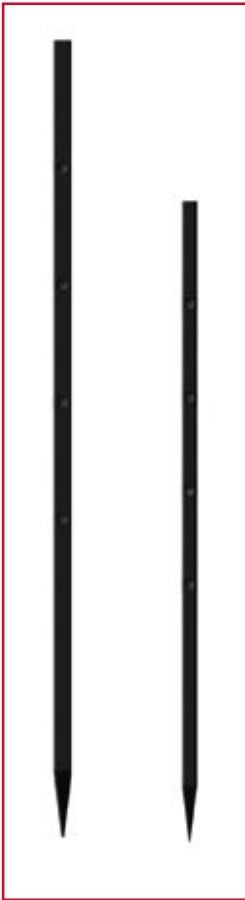

ITEM	DESCRIPTION	PCS/CTN	PCS/PLT
901565	3/8" x 1 1/2" x 12" Flat Stake "C-Type"	10 pcs	1200
901572	3/8" x 1 1/2" x 18" Flat Stake "C-Type"	10 pcs	800
901589	3/8" x 1 1/2" x 24" Flat Stake "C-Type"	10 pcs	550
901596	3/8" x 1 1/2" x 30" Flat Stake "C-Type"	10 pcs	450
901602	3/8" x 1 1/2" x 36" Flat Stake "C-Type"	10 pcs	400
901619	3/8" x 1 1/2" x 42" Flat Stake "C-Type"	10 pcs	350
901626	3/8" x 1 1/2" x 48" Flat Stake "C-Type"	10 pcs	300
901633	1/2" x 1 1/2" x 12" Flat Stake "C-Type"	10 pcs	650
901640	1/2" x 1 1/2" x 18" Flat Stake "C-Type"	10 pcs	450
901657	1/2" x 1 1/2" x 24" Flat Stake "C-Type"	10 pcs	350
901664	1/2" x 1 1/2" x 30" Flat Stake "C-Type"	10 pcs	300
901671	1/2" x 1 1/2" x 36" Flat Stake "C-Type"	10 pcs	250
901688	1/2" x 1 1/2" x 42" Flat Stake "C-Type"	10 pcs	200
901695	1/2" x 1 1/2" x 48" Flat Stake "C-Type"	10 pcs	150
901701	5/8" x 5/8" x 12" Square Stake	10 pcs	1500
901718	5/8" x 5/8" x 18" Square Stake	10 pcs	1000
901725	5/8" x 5/8" x 24" Square Stake	10 pcs	800
901732	5/8" x 5/8" x 30" Square Stake	10 pcs	700
901749	5/8" x 5/8" x 36" Square Stake	10 pcs	600
901756	5/8" x 5/8" x 42" Square Stake	10 pcs	500
901763	5/8" x 5/8" x 48" Square Stake	10 pcs	400
901770	3/4" x 3/4" x 12" Square Stake	10 pcs	1200
901787	3/4" x 3/4" x 18" Square Stake	10 pcs	800
901794	3/4" x 3/4" x 24" Square Stake	10 pcs	550
901800	3/4" x 3/4" x 30" Square Stake	10 pcs	450
901817	3/4" x 3/4" x 36" Square Stake	10 pcs	400
901824	3/4" x 3/4" x 42" Square Stake	10 pcs	350
901831	3/4" x 3/4" x 48" Square Stake	10 pcs	300

Rod Chair

Provides support for the placement reinforcing bars.
Rod chairs are inexpensive & easy to use.
Made of Low carbon cold-rolled wire.

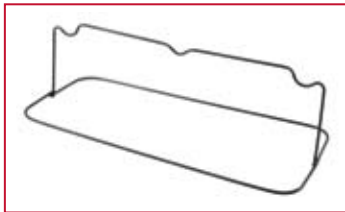
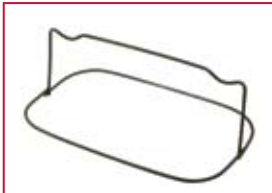

ITEM	ROD CHAIR	DIAMETER	DESCRIPTION	PCS/CTN
902005	Two-dipped	2.9mm	195mm x 125mm x 85mm	100
902012	Two-dipped	2.9mm	203mm x 147mm x 94mm	100
902029	Three-dipped	2.9mm	292mm x 137mm x 83mm	100
902036	Three-dipped	2.9mm	306mm x 125mm x 85mm	100

High Chair



ITEM	THICKNESS	HIGH
902166	4.5mm	60mm
902173	4.5mm	70mm
902180	4.5mm	80mm
902197	4.5mm	90mm
902203	4.5mm	100mm
902210	5.0mm	110mm
902227	5.0mm	120mm
902234	5.0mm	130mm
902241	5.5mm	140mm
902258	5.5mm	150mm

Bar Chair

Supports reinforcement. Flat base adds stability while pouring concrete.
Made of low carbon steel.

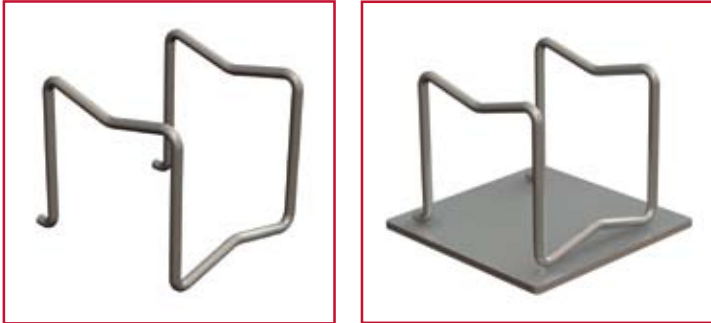

ITEM	THICKNESS	HEIGHT
902043	4.0mm	30mm
902050	4.0mm	40mm
902067	4.5mm	50mm
902074	4.5mm	60mm
902081	4.5mm	70mm
902098	4.5mm	80mm
902104	4.5mm	90mm
902111	4.5mm	100mm
902128	5.0mm	110mm
902135	5.0mm	120mm
902142	5.5mm	130mm
902159	5.5mm	150mm

Continuous High Chair

Provides excellent support for rebar. Long continuous design carries load well and resists overturning.
Made of low carbon steel.

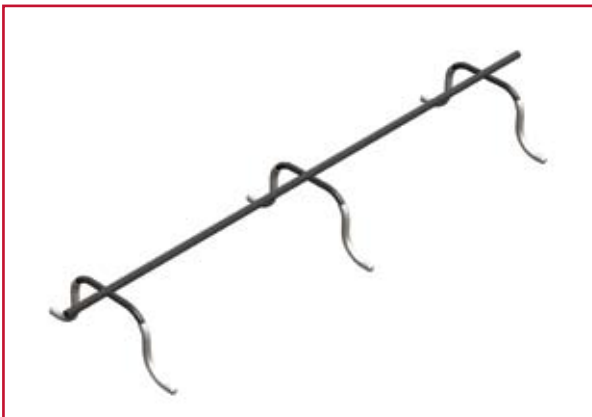

ITEM	SIZE	APROX. WEIGHT (LF)
902647	2"	33
901879	2 1/8"	33
902661	2 1/2"	33
901886	2 3/4"	33
902685	3"	33
901893	3 1/4"	36
901909	3 1/2"	36
901916	3 3/4"	36
901923	4"	36
902890	4 1/4"	39
902746	4 1/2"	39
902906	4 3/4"	39
902913	5"	39
901930	5 1/4"	53
901947	5 1/2"	53
901954	5 3/4"	53
901961	6"	53

Anchor Bolt

Anchor bolts are preset into concrete. The threaded portion are used to fasten structures or equipment.
Made of carbon steel.



BRIGHT w/ washer & nut

ITEM	DIAMETER	LENGTH	BEND	PCS/CTN
903002	1/2"	6"	1 1/4"	50
903019	1/2"	8"	1 1/4"	50
903026	1/2"	10"	1 1/4"	50
903033	1/2"	12"	1 1/4"	50
903040	1/2"	14"	1 1/4"	25
903057	1/2"	16"	1 1/4"	25
903149	5/8"	10"	1 1/4"	25
903156	5/8"	12"	1 1/4"	25

HOT DIPPED GALVANIZED w/ washer & nut

ITEM	DIAMETER	LENGTH	BEND	PCS/CTN
903064	1/2"	6"	1 1/4"	50
903071	1/2"	8"	1 1/4"	50
903088	1/2"	10"	1 1/4"	25
903095	1/2"	12"	1 1/4"	25
903101	1/2"	14"	1 1/4"	25
903118	1/2"	16"	1 1/4"	25

BRIGHT w/ 3"x3" Square Slotted Washer

ITEM	DIAMETER	LENGTH	BEND	PCS/CTN
903125	1/2"	10"	1 1/4"	50
903132	5/8"	10"	1 1/4"	25

Slab Bolsters

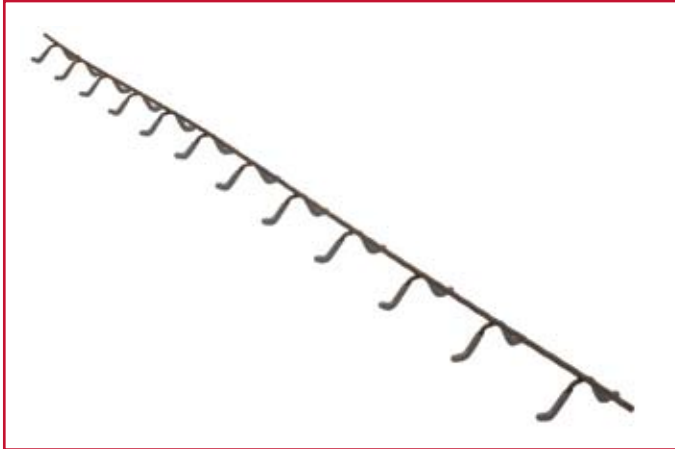

ITEM	SIZE	APROX. WEIGHT (LF)
902265	3/4"	19
902272	1"	20
902289	1 1/4"	25
902296	1 1/2"	25
902302	1 3/4"	25
902319	2"	25
902326	2 1/4"	28
902333	2 1/2"	28
902340	2 3/4"	31
902357	3"	31

Slab Bolster Upper

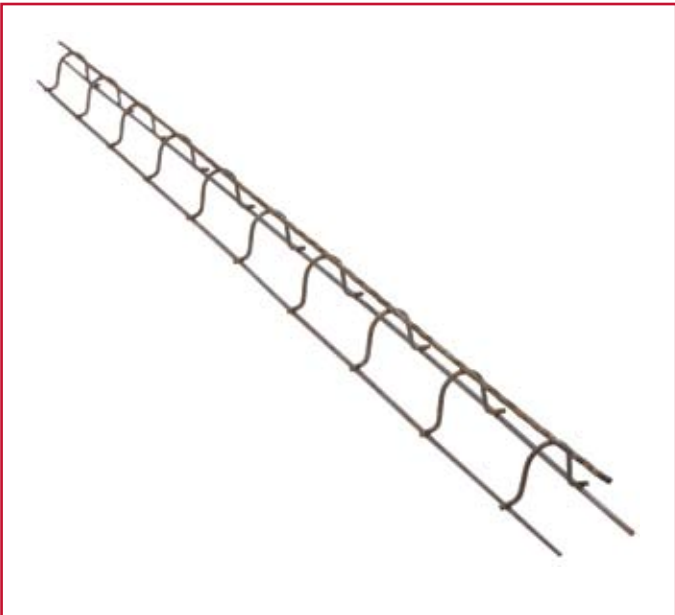

ITEM	SIZE	APROX. WEIGHT (LF)
902364	3/4"	36
902371	1"	38
902388	1 1/4"	42
902395	1 1/2"	42
902401	1 3/4"	42
902418	2"	45
902425	2 1/4"	45
902432	2 1/2"	48
902449	2 3/4"	48
902456	3"	48

Beam Bolster



ITEM	SIZE	APROX. WEIGHT (LF)
902463	1"	25
902470	1¼"	25
902487	1½"	28
902494	1¾"	28
902500	2"	28
902517	2¼"	31
902524	2½"	31
902531	2¾"	31
902548	3"	33

Beam Bolster Upper

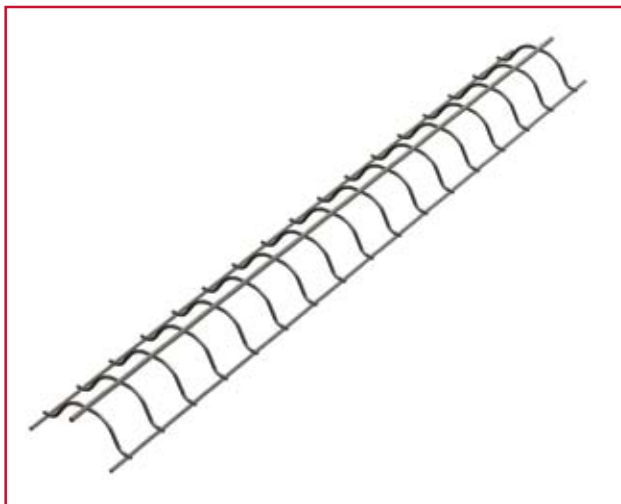

ITEM	SIZE	APROX. WEIGHT (LF)
902555	1"	42
902562	1¼"	42
902579	1½"	42
902586	1¾"	45
902593	2"	45
902609	2¼"	48
902616	2½"	48
901855	2¾"	48
901862	3"	51

Bar Tie

Bar Ties are used to secure the position of reinforcing bars in concrete construction.

Made of low carbon steel wire.

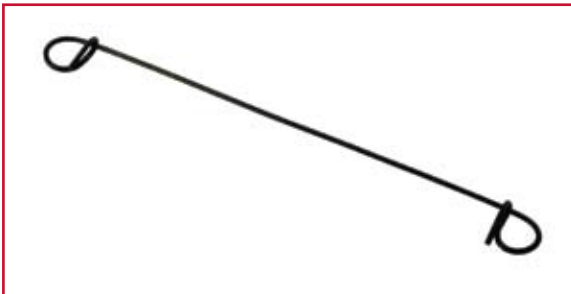

ITEM	LENGTH	GAUGE	PCS/ROLL
904009	6"	16	5000
904016	8"	16	5000
904023	10"	16	5000
904030	6"	17	5000
904047	8"	17	5000
904054	10"	17	5000

Tie Wire

Tie wire are used to secure the position of reinforcing bars in concrete construction.

Made of low carbon steel wire.



ITEM	GAUGE	DESCRIPTION	PACKAGING	WT/CTN
660080	9	Black Annealed Tie Wire	20	70
660097	9	Galvanized Tie Wire	20	70
660349	9	Black Annealed Tie Wire	1	100
660363	9	Galvanized Tie Wire	1	100
660417	12	Black Annealed Tie Wire	1	100
660424	16	Black Annealed Tie Wire	1	100